

Mounting template - Tension feet



Mount the fixing plates by use of the mounting template.

Attention: In order to avoid any glass damage, a minimum distance to the pane has to be kept!

Transparent fabric min. 3 mm ventilation distance.

Blackout fabric min. 5 mm ventilation distance.

Honeycomb fabric min. 20 mm ventilation distance.

(Special glass may according to instructions from the manufacturer require bigger distance).

1. Push the fixing plate into the mounting template.

Attention: +5 and +3 respectively is the requested minimum distance to the pane (ventilation distance).

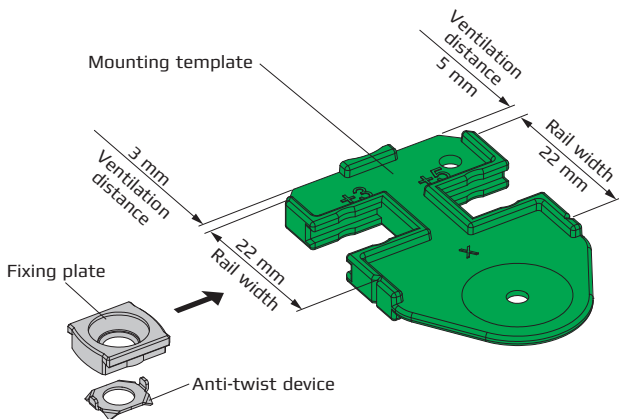

2. Position the mounting template on the glazing bead (directly against the pane).

3. Pre-drill and fix the fixing plates.

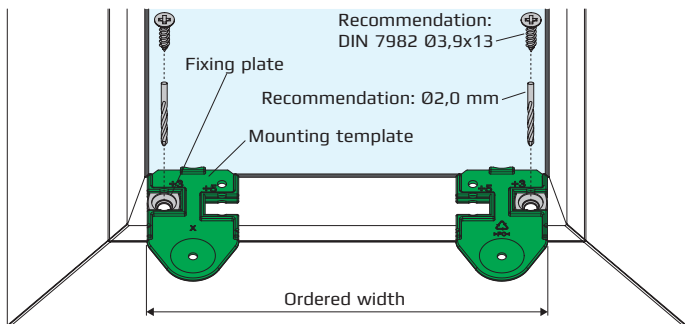

4. Pull the mounting template from the fixing plate.

Mounting template - Tension feet

**Mount the tension feet individually
(to the front edge of the glazing bead edge)**

